

The 1572 series is an excellent general purpose capillary suitable for a wide range of applications on a variety of metalizations. This series employs the 120° double IC and 8° face angle architecture. The 120° IC provides maximum downward force for a strong 1st bond with high ball-shear strength and is not prone to cut-stitch on the 2nd bond. The 8° face angle is the most versatile for handling a variety of stitch-bond metalizations. Many different Hole and B and T size combinations are available in the different dash numbers of the 1572 series. In general, the 1572 series will have smaller feature sizes for a given dash number.

The 1572N may be specified for a 90° inside chamfer for improved 2nd bond tailing and a more compact ball bond on materials with good bondability.

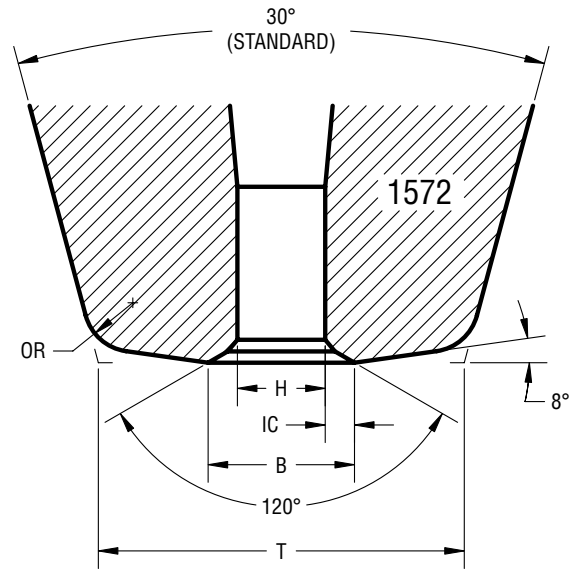
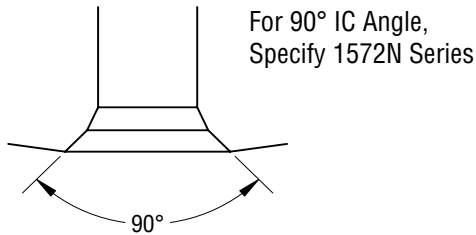

**Specify:** Series - Dash Number - Length + Finish - Options  
**Example:** 1572-18-437GM

Note: For Tungsten Carbide material, specify 1172 & 1172N series (1/16 in. diameter only). For 1/8 in. diameter ceramic, specify 1272 & 1272N series.

SERIES & DASH NO.	H* in. / μm ±0.0001 / 2.5	IC in. / μm (Ref)	B in. / μm See Note**	OR in. / μm ±0.0003 / 8	T (30° CONE) in. / μm ±0.0003 / 8	T (20° CONE) in. / μm ±0.0003 / 8	SUGGESTED WIRE DIAMETER in. / μm
1572-10	0.0010 / 25	0.0007 / 18	0.0024 / 61	0.0008 / 20	0.0055 / 140	0.0056 / 142	0.0005 / 13 to 0.0008 / 20
1572-10S	0.0010 / 25	0.0004 / 10	0.0018 / 46	0.0008 / 20	0.0055 / 140	0.0056 / 142	
1572-12	0.0012 / 30	0.0006 / 15	0.0024 / 61	0.0008 / 20	0.0055 / 140	0.0056 / 142	0.0007 / 18 to 0.0009 / 23
1572-13	0.0013 / 33	0.0006 / 15	0.0025 / 64	0.0008 / 20	0.0055 / 140	0.0056 / 142	
1572-13S	0.0013 / 33	0.0004 / 10	0.0021 / 53	0.0008 / 20	0.0055 / 140	0.0056 / 142	0.0008 / 20 to 0.0010 / 25
1572-15	0.0015 / 38	0.0007 / 18	0.0029 / 74	0.0010 / 25	0.0065 / 165	0.0067 / 170	
1572-15S	0.0015 / 38	0.0006 / 15	0.0027 / 69	0.0008 / 20	0.0055 / 140	0.0056 / 142	0.0009 / 23 to 0.0011 / 28
1572-17	0.0017 / 43	0.0006 / 15	0.0029 / 74	0.0010 / 25	0.0090 / 229	0.0092 / 234	
1572-17S	0.0017 / 43	0.0006 / 15	0.0029 / 74	0.0010 / 25	0.0065 / 165	0.0067 / 170	0.0010 / 25 to 0.0013 / 33
1572-18	0.0018 / 46	0.0006 / 15	0.0030 / 76	0.0010 / 25	0.0090 / 229	0.0092 / 234	
1572-20	0.0020 / 51	0.0010 / 25	0.0040 / 102	0.0015 / 38	0.0090 / 229	0.0093 / 236	0.0013 / 33 to 0.0015 / 38
1572-22	0.0022 / 56	0.0009 / 23	0.0040 / 102	0.0015 / 38	0.0090 / 229	0.0093 / 236	
1572-25	0.0025 / 64	0.0013 / 33	0.0051 / 130	0.0020 / 51	0.0115 / 292	0.0118 / 300	0.0015 / 38 to 0.0020 / 51
1572-30	0.0030 / 76	0.0013 / 33	0.0056 / 142	0.0025 / 64	0.0130 / 330	0.0134 / 340	0.0020 / 51
1572-35	0.0035 / 89	0.0010 / 25	0.0055 / 140	0.0030 / 76	0.0140 / 356	0.0145 / 368	0.0020 / 51 to 0.0025 / 64
1572-40	0.0040 / 102	0.0010 / 25	0.0060 / 152	0.0030 / 76	0.0140 / 356	0.0145 / 368	0.0030 / 76
1572-50	0.0050 / 127	0.0013 / 33	0.0076 / 193	0.0030 / 76	0.0160 / 406	0.0165 / 419	0.0040 / 102
1572-70	0.0070 / 178	0.0015 / 38	0.0100 / 254	0.0050 / 127	0.0280 / 711	0.0288 / 732	0.0050 / 127
1572-100	0.0100 / 254	0.0020 / 51	0.0140 / 356	0.0070 / 178	0.0380 / 965	0.0391 / 993	0.0060 / 152

\* For hole sizes 0.0025 through 0.0049, the tolerance is +0.0002/-0.0001. For hole sizes greater than 0.0049, the tolerance is +0.0003/-0.0002. Tighter tolerance available at additional charges.

\*\* If IC < 0.0005 and/or T < 0.0050, the B tolerance is +/-0.0001, otherwise B tolerance is +/-0.0002 (if B > 0.0040, B tolerance is +0.0003/-0.0002). Dimensions in inches unless otherwise specified.